

THREADED & FSW ENDS						
SIZE	MAT'L	DIMENSIONS, INCHES				WGT. LBS.
		A	B [Ⓐ]	C	D	
1/2 & 3/4"	DI/BRZ	3.62	9.00	1.69	5.12	10
	CS/SS	3.62	9.00	1.69	5.12	12
1"	DI/BRZ	4.12	11.25	2.62	7.09	21
	CS/SS	4.18	11.50	2.62	7.09	25
1 1/4"	DI/BRZ	4.12	11.25	2.62	7.09	21
1 1/2"	DI/BRZ	4.50	11.25	2.31	7.09	23
	CS/SS	4.81	11.75	2.25	7.09	31
2"	DI/BRZ	4.50	11.50	2.75	7.09	26
	CS/SS	5.50	11.75	2.75	7.09	35

FLANGED END									
SIZE	ANSI FLANGE	DIMENSIONS, INCHES						Wt. lbs.	
		A ₁		B [Ⓐ]		C	D		
		DI/BRZ	CS/SS	DI/BRZ	CS/SS	ALL	ALL	DI/BRZ	CS/SS
1/2"	150#	7.25	7.25	9.00	9.00	1.69	5.12	13	15
	300#	7.50	7.50	9.00	9.00	1.69	5.12	14	16
3/4"	150#	7.25	7.25	9.00	9.00	1.69	5.12	14	16
	300#	7.62	7.62	9.00	9.00	1.69	5.12	16	17
1"	150#	7.25	7.25	11.25	11.75 [Ⓓ]	2.62	7.09	26	34
	300#	8.75 [Ⓓ]	7.75 [Ⓓ]	11.25	11.75 [Ⓓ]	2.62	7.09	28	37
1 1/4"	150#	7.87		11.25		2.62	7.09	28	
	300#	8.37		11.25		2.62	7.09	31	
1 1/2"	150#	8.75	8.75	11.25	13.00 [Ⓓ]	2.31	7.09	42	46
	300#	10.25 [Ⓓ]	9.25 [Ⓓ]	11.25	13.00 [Ⓓ]	2.31	7.09	45	52
2"	150#	10.00	10.00	11.50	13.25 [Ⓓ]	2.75	7.09	46	50
	300#	10.50	10.50	11.50	13.25 [Ⓓ]	2.75	7.09	49	55

- Ⓓ NOT ANSI STD.
- Ⓔ IFE ONLY

TOLERANCES

BWE, FE, TRI-C & TUBE END DIM ARE ±1/16"
ALL OTHER DIMENSIONS: ±1/2"

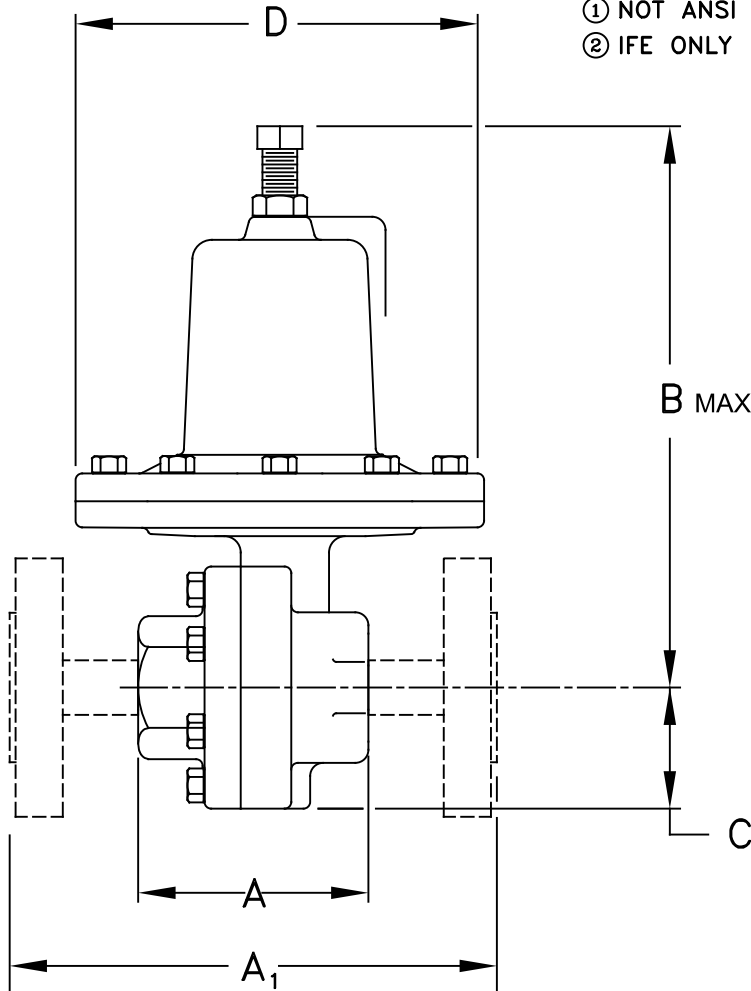

MK50 & 60

SPECIFICATION DATA

CUSTOMER _____
ORDER No. _____ SERIAL No. _____
TAG No. _____
VALVE TYPE _____ QTY. _____
BODY _____
END CONN. _____
INLET PRESS. _____ MAX. ΔP _____
PRESS. RANGE _____ SET AT _____
VALVE ACTION: RISE IN PRESSURE TO OPEN
 CLOSE
VALVE SEAT _____ Cv _____
MISC. _____
CERTIFIED _____ DATE _____

RICHARDS
INDUSTRIALS
CINCINNATI, OHIO

F.N.: MK50 A JEC 09085 9/14/09 JLM

1/2-2" MARK 50 & 60
BACK PRESSURE REGULATOR & PRESSURE REDUCING VALVE.

DRAWN BY: JLA DATE: 1/4/96
CHECKED BY: _____ DATE: _____

MK50/60