

THREADED & FSW ENDS						
VALVE SIZE	MAT'L	DIMENSIONS, INCHES				Wt. lbs. ③
		A	B ①	C	D ②	
1/4" & 3/8"	DI/BRZ	4.52	9.38	2.18	9.5	24
	CS/SS	4.55	9.38	2.18	9.5	24

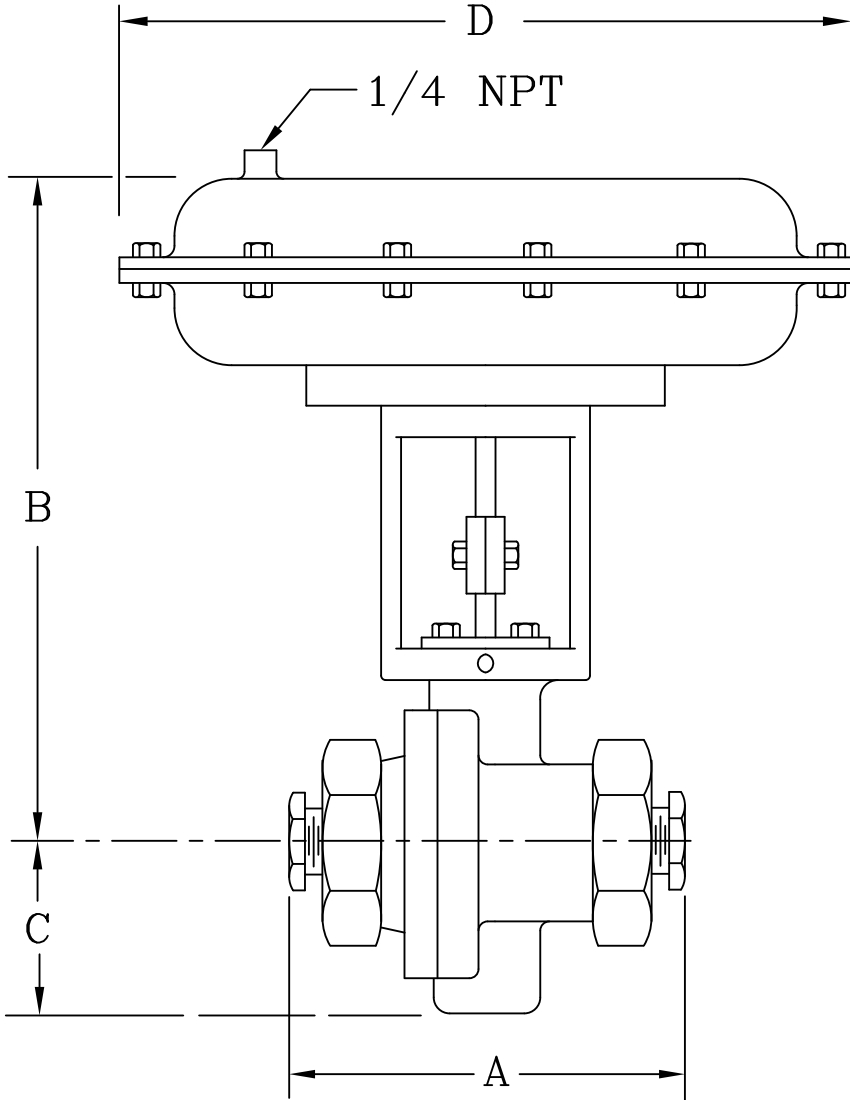

TOLERANCES

BWE, FE, TRI-C & TUBE END DIM ARE ±1/16"
ALL OTHER DIMENSIONS: ±1/2"

SPECIFICATION DATA	
CUSTOMER _____	_____
ORDER No. _____	SERIAL No. _____
TAG No. _____	_____
VALVE TYPE _____	QTY. _____
BODY _____	_____
END CONN. _____	_____
INLET PRESS. _____	MAX. ΔP _____
CONTROL RANGE _____	_____
VALVE ACTION: RISE IN SIGNAL TO	<input type="checkbox"/> OPEN
	<input type="checkbox"/> CLOSE
VALVE SEAT _____	Cv _____
MISC. _____	_____
CERTIFIED _____	DATE _____

- ① B DIMENSIONS ARE FOR 35M ACTUATOR; FOR 55M ACTUATOR ADD 1.2", FOR 85M ACTUATOR ADD 2".
- ② D DIMENSIONS ARE FOR 35M ACTUATOR; FOR 55M ACTUATOR ADD 3", FOR 85M ACTUATOR ADD 5.5".
- ③ WEIGHTS ARE FOR 35M ACTUATOR; FOR 55M ACTUATOR ADD 11#, FOR 85M ACTUATOR ADD 20#.

FN: MK70-025

JORDAN VALVE
a division of Richards Industries
CINCINNATI, OHIO U.S.A
www.jordanvalve.com

1/4" - 3/8" MARK 70
DIAPHRAGM CONTROL VALVE

DRAWN BY	DATE
UAS	7/13/16
CHECKED BY	DATE

MK70